

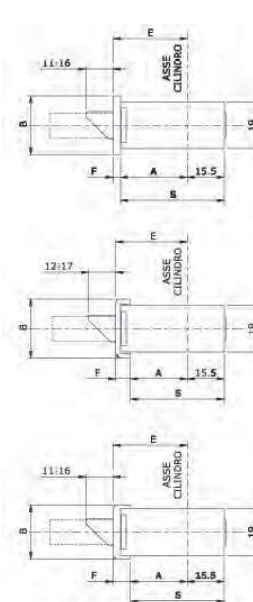

Code

Min. ord.
Multiple
package
Single
package

Blindo 92 mm centre distance

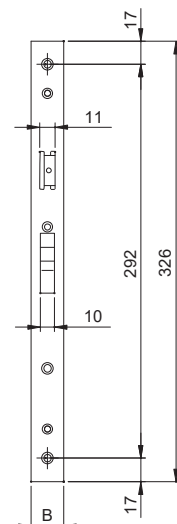
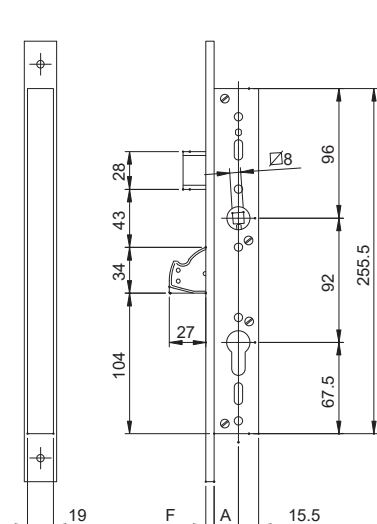

Codice					
Art.	E	A	S	B	F
7911	10	25	2	22	37.5
	30			27	42.5
	35			32	47.5
	40			37	52.5

Codice					
Art.	E	A	S	B	F
7911	00	25	2	18	33.5
	30			23	38.5
	35			28	43.5
	40			33	48.5

Codice					
Art.	E	A	S	B	F
7911	50	25	0	18	33.5
	30			23	38.5
	35			28	43.5
	40			33	48.5

BLINDO mortice lock for metal frames, LATERAL LOCKING, **ROTATING DEADBOLT.**

Centre distance mm 92, operating with European profile cylinder.

Rotating deadbolt, mm 27 throw, with antidrill/anticut cover plates in carbonitrided steel.

Supplied with reversible and adjustable latchbolt. The latchbolt can be replaced with roller or cap for deadlocking only. Latchbolt/roller operated by key or mm 8 handle follower. Cylinder screw.

2 nylon end blocks for U-version. Instruction sheet.

Accessories to be ordered separately:

Striking plates

Modular roller for latchbolt hole - ref. N. 040801/2/3/4

Cylinder escutcheon - ref. N. 040809

Antidrill plate - ref. N. 040805. 25/30/35/40

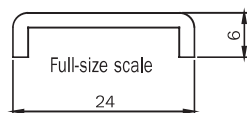

U-front plate mm 326x24x6 in stainless steel. Backset mm 25	791100252	1	10	10
U-front plate mm 326x24x6 in stainless steel. Backset mm 30	791100302	1	10	10
U-front plate mm 326x24x6 in stainless steel. Backset mm 35	791100352	1	10	10
U-front plate mm 326x24x6 in stainless steel. Backset mm 40	791100402	1	10	10

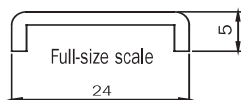

U-front plate mm 326x24x5 in stainless steel. Backset mm 25	791133252	1	10	10
U-front plate mm 326x24x5 in stainless steel. Backset mm 30	791133302	1	10	10
U-front plate mm 326x24x5 in stainless steel. Backset mm 35	791133352	1	10	10
U-front plate mm 326x24x5 in stainless steel. Backset mm 40	791133402	1	10	10



Code

Single
package

Min. ord.

Blindo 92 mm centre distance

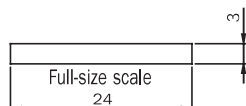

Flat front-plate mm 326x24x3 in stainless steel. Backset mm 25	791110252	1	10	10
Flat front-plate mm 326x24x3 in stainless steel. Backset mm 30	791110302	1	10	10
Flat front-plate mm 326x24x3 in stainless steel. Backset mm 35	791110352	1	10	10
Flat front-plate mm 326x24x3 in stainless steel. Backset mm 40	791110402	1	10	10



Flat front-plate mm 326x22x3 in stainless steel. Backset mm 25	791112252	1	10	10
Flat front-plate mm 326x22x3 in stainless steel. Backset mm 30	791112302	1	10	10
Flat front-plate mm 326x22x3 in stainless steel. Backset mm 35	791112352	1	10	10
Flat front-plate mm 326x22x3 in stainless steel. Backset mm 40	791112402	1	10	10

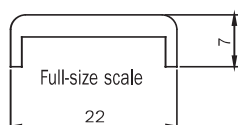

U-front plate mm 326x22x7 in BLACK PAINTED aluminium. Backset mm 25	791150250	1	10	10
U-front plate mm 326x22x7 in BLACK PAINTED aluminium. Backset mm 30	791150300	1	10	10
U-front plate mm 326x22x7 in BLACK PAINTED aluminium. Backset mm 35	791150350	1	10	10
U-front plate mm 326x22x7 in BLACK PAINTED aluminium. Backset mm 40	791150400	1	10	10



Code

Min. ord.
Multiple
package
Single
package

Accessories



Modular roller for MULTIBLINDO and BLINDO with a nylon insert for fixed striking plate and a nylon insert for adjustable striking plate. It can replace the latchbolt.

For lock backset mm 25	040801	10	-	10
For lock backset mm 30	040802	10	-	10
For lock backset mm 35	040803	10	-	10
For lock backset mm 40	040804	10	-	10
For lock backset mm 45	040811	10	-	10
For lock backset mm 50	040812	10	-	10
For lock backset mm 55	040813	10	-	10
For lock backset mm 60	040814	10	-	10
For lock backset mm 65	040815	10	-	10



Modular cap for MULTIBLINDO and BLINDO for backsets from 25 mm to 65 mm. In NYLON. To be fitted instead of the latchbolt for only deadbolt versions. Screw.

040816	10	-	10
---------------	----	---	----



MODULAR ANTIDRILL PLATE for MULTIBLINDO and BLINDO.

To be fixed to the lock for pin protection.

For lock backset mm 25	040805.25	10	-	10
For lock backset mm 30	040805.30	10	-	10
For lock backset mm 35	040805.35	10	-	10
For lock backset mm 40	040805.40	10	-	10
For lock backset mm 45	040805.45	10	-	10
For lock backset mm 50	040805.50	10	-	10
For lock backset mm 55	040805.55	10	-	10
For lock backset mm 60	040805.60	10	-	10
For lock backset mm 65	040805.65	10	-	10



UPPER STRIKER for MULTIBLINDO, vertical locking. 2 tip-guiding plates \varnothing mm 14.

Rod-guiding nylon spacer.

040806	10	-	10
---------------	----	---	----

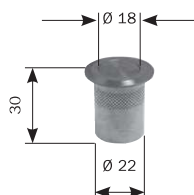

Brass FLOOR SOCKET with antidust spring cap for rods.

Inside hole \varnothing mm 18. For MULTIBLINDO tip bolt.

040807	10	-	10
---------------	----	---	----



Code

Min. ord.
Multiple
package
Single
package

Accessories



Multi-faceted Ø mm 14 TIP for threaded rods M8. For MULTIBLINDO.
In zinc-plated carbonitrided steel.
Elastic pin. Drawing pin.

040808 10 - 10

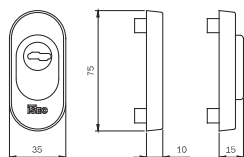

MODULAR ESCUTCHEON for MULTIBLINDO and BLINDO, European profile cylinder, internal fixing.
Internal and external escutcheons in aluminium. External plate and antidrill disk
in carbonitrided steel. Plate spacer. Spacers. Antidrill balls for screw protection. Screws.
BLACK PAINTED

040809 1 - 1

MODULAR ESCUTCHEON for MULTIBLINDO and BLINDO, European profile cylinder, internal fixing.
Internal and external escutcheons in aluminium. External plate and antidrill disk in carbonitrided steel.
Plate spacer. Spacers. Anti-drill balls for screw protection. Screws.
RAW ALUMINIUM

040809G 1 - 1

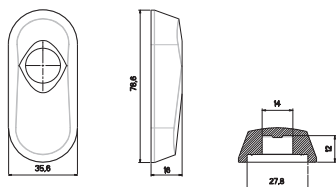

IRON. ESCUTCHEON for European profile cylinder. **Tempered steel.**
Internal escutcheon in nylon. Fixing screws.
For projecting cylinders 4 a 11,3 mm.

SATIN NICKEL PLATED	0000098050204	1	-	1
BLACK PAINTED	0000098050205	1	-	1
POLISHED BRASS PLATED	0000098050206	1	-	1